

AUTOMATIC URINAL FLUSHER

NOTES PRIOR TO INSTALLATION

- Check accessories, if any missing, please contact the local dealer.
- Read the instructions carefully prior to installation, and make a reasonable plan.
- Don't position the product directly to the sunshine or strong light to avoid any damage to product features.
- Please wash clean of the water supply pipe before installation to avoid any damage of the solenoid valve.
- Please turn off the water supply before installation and don't put wrong direction of the control box.
- Don't use any acid or alkaline detergent cleaser for cleaning.

Features

- 1 Smart flushing system, automatic adjustment of flushing time depends on actual use.
- 2 DC power supply (batteries prepared by users) should be 3 AA alkaline batteries, that can be used for 3 years (on 100 times uses per day).
- 3 AC power supply is 100-240V AC.
- 4 Intelligent control system to offer the best sensor range.
- 5 Water-proof structure for electronic components.
- 6 Automatic refresh for no-use of each 24-hour, to avoid odors reverse.
- 7 Status and low voltage indicators to provide easy use and maintenance.

Part Identification

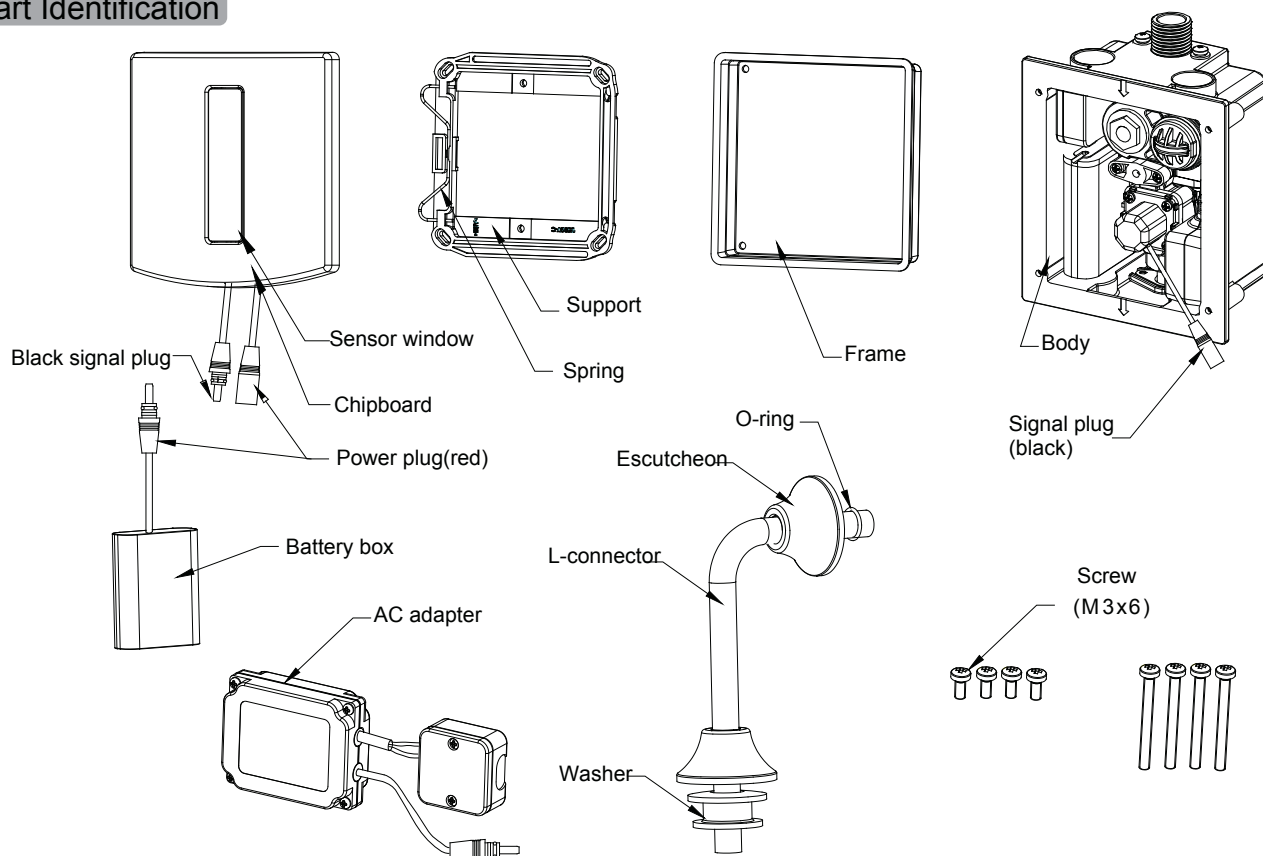

Pic.1 Parts Name

Instruction Sketch

Standard Installation Dimensions (Unit mm)

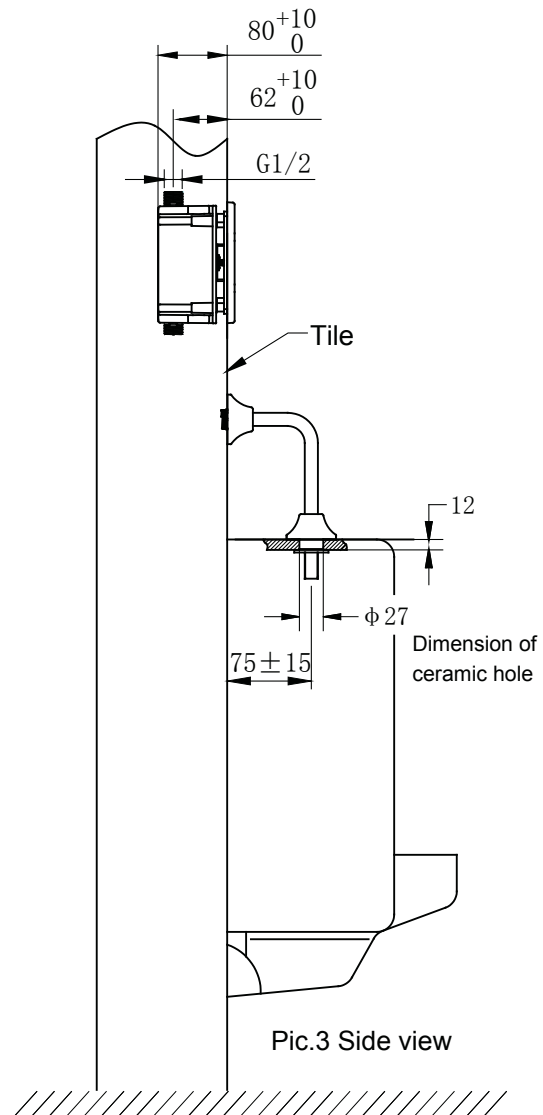
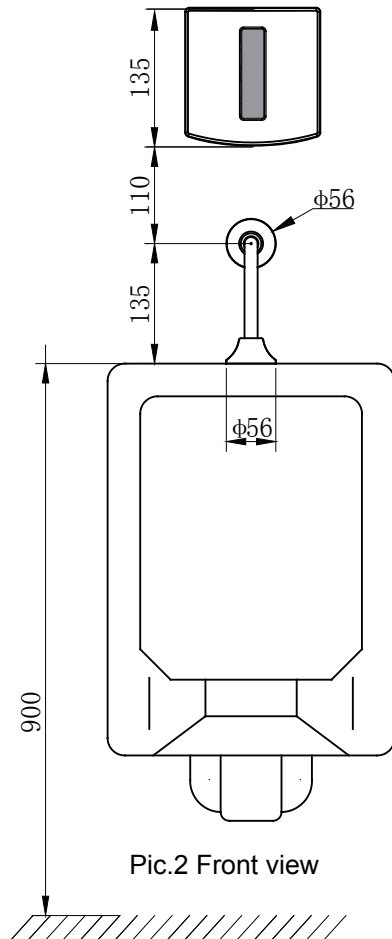

Installation of mount-in box

Referring to Picture 3 & Picture 4 for the hole size on the wall, and make water pipes in order, and connecting with the inlet & outlet hoses, also put right the mount-in box with level.

- ★ Make cables in order if by AC power supply.
- ★ Testing each connector after finishing pipes connection, and go to the next step after turning off the water and making sure no leakage.

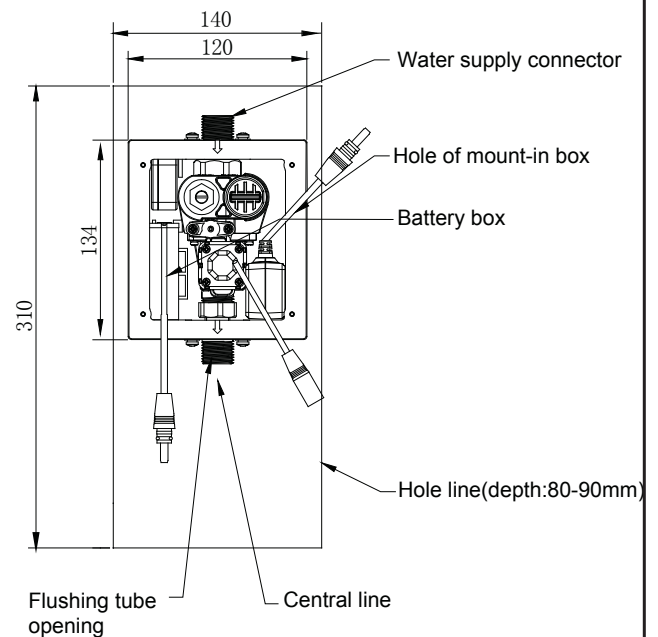

Installation

2. Battery and its replacement

- ★No batteries are included, users prepare it before installation.
- ★Please choose fine AA alkaline batteries to avoid any trouble.

- 2.1 Please take out the battery box from the control box, and open it as Picture 6 showing;
- 2.2 Put 3 AA alkaline batteries into the box with right direction, and fix with the box cap;
- 2.3 Put back the battery box to the control box as the Picture 4 showing.

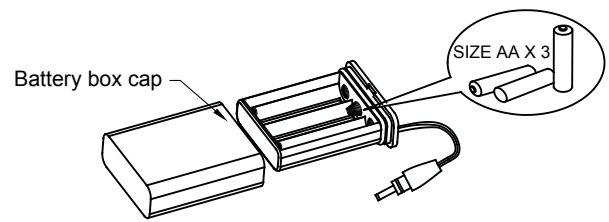

Pic.5 Installation of batteries

3. Installation of AC adapter

AC power cords(prepared by users)

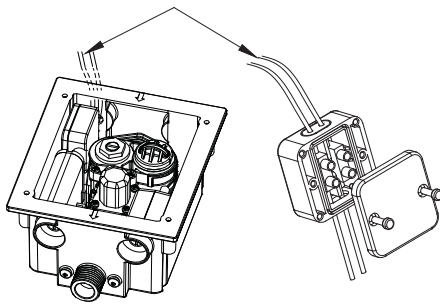

Pic.6 Installation of AC adapter

- 3.1 Unscrew the adapter box and open the cover of it;
- 3.2 Connecting through the AC cords into the cords box, and then fix right on the cords base ;
- 3.3 Put back the battery box to the control box.

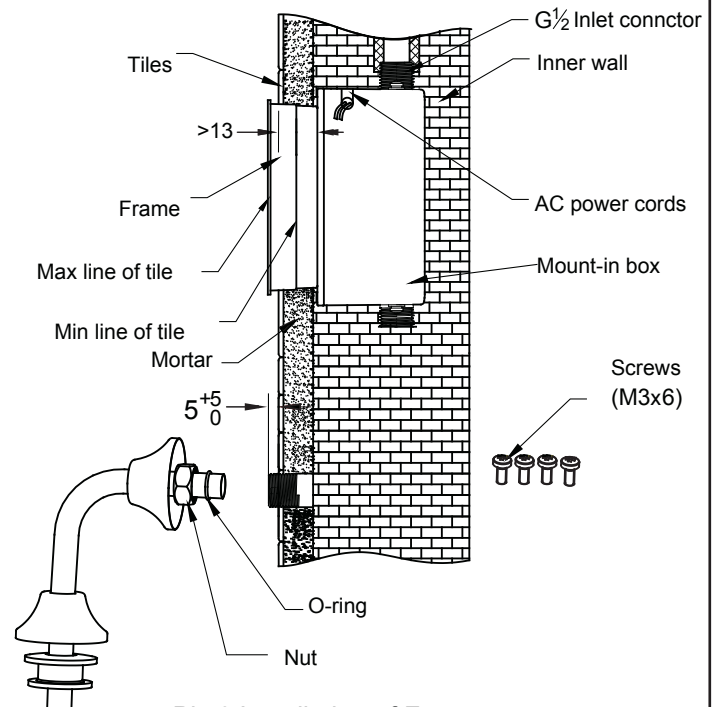

Pic.6 Installation of Frame

4. Installation of frame

Making 10-minute water going through to test if any leakage, and then fix the frame to the mount-in box by M3*6 screws, that can avoid damage to the inner components of the mount-in box and also leave enough space to the frame area. Taking out the frame after the cement have been dried enough.

- ★ Making cables in order for UPS power supply.

5. Installation and removal of Escutcheon panel/support frame

- 5.1 Take out the support of the panel and fix it with 4 screws on top of the preset box, and make sure of it being level with the wall, and also put through the wires from the hole of support as Picture 7 showing;
- 5.2 Connecting the wire and signal cord separately with the wires of the preset box;
- 5.3 Tilt 20 degree of the panel, and then put the spring right with the panel, making level of the inner panel and the frame of the support, pushing from the left to the right till the support is locking with the panel;
- 5.4 Pushing from the left to the right and tilt 20 degree by the right side till unlock the frame, and then pushing to the left to take out the panel;
- 5.5 Disconnecting the wires and cords with the preset box; Unscrew the support and take it out.

Note

- ★Make sure no loosen of the connection of wires.
- ★Once any needs to adjust flow rate or replace batteries.
- ★Once any needs to clean the filter screen.
- ★When connecting the sensor wires, please don't cover the sensor with your hand or something else in case to impact to the auto-setting of the sensing distance. (The auto-setting will be completed within 20 seconds.)

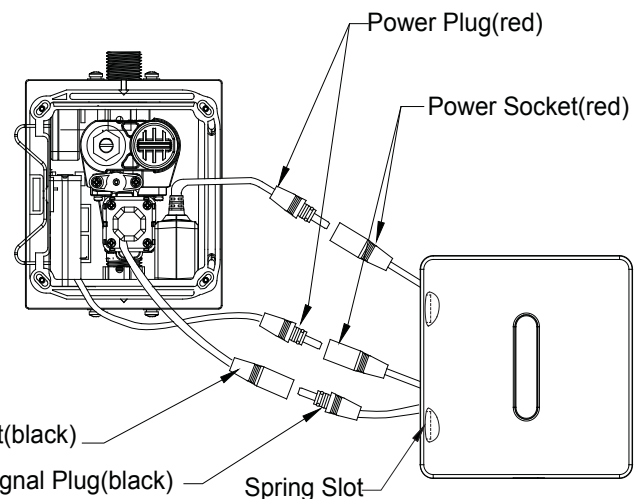

Pic. 7 Escutcheon panel installation

Instructions

1. Debugging

- 1.1 Turn on the water supply;
- 1.2 After connecting the batteries and sensor cords, the sensor unit starts for environment detection with light flashing, please do not make any action within the sensor range, till 10 minutes later than the light stops flashing.

2. Instructions

- 2.1 Duration more than 3 seconds, it flashes, and the flusher starts for 5s pre-flush to clean the ceramic bowl; If the interval less than 1s, there is no pre-flush;
- 2.2 The sensor is activated, but do not flush during using;
- 2.3 After the user leave the range, the flusher starts for 5s to 15s flush.

Notes

- ★ Please check all connections to make sure no leakage before use.

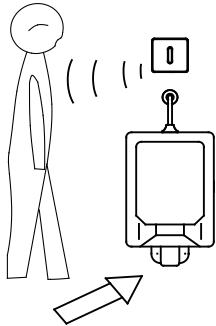

Pic.8 Go into sensor range

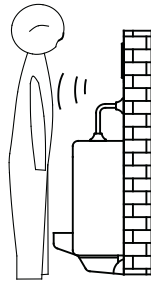

Pic.9 In use

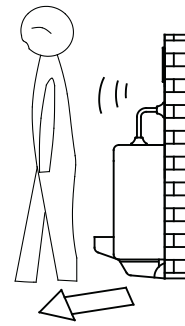

Pic.10 Leave the range

3. Low-voltage Indication

- ★ If it flashes slowly, it may be in low batteries, please replace with new AA alkaline batteries.

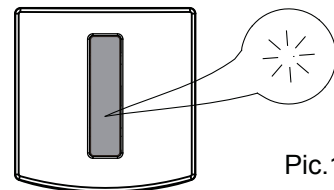

Pic.11

4. Flow rate adjustment (Picture 12)

- 4.1 There is flow regulator to reset the flow rate;
- 4.2 Change the flow rate by actual needs.

5. Filter screen clean (Picture 12)

- 5.1 If any circumstances of low flow rate, please try to clean the filter screen;
- 5.2 Turn off the power supply;
- 5.3 Take out the escutcheon panel, and unscrew the support to get it out;
- 5.4 Unscrew the screw of the filter part, and take out the filter screen;
- 5.5 Wash if any debris or sundries;
- 5.6 Put everything back to right place after clean, turn on the water supply and check to make sure no leakage before use.

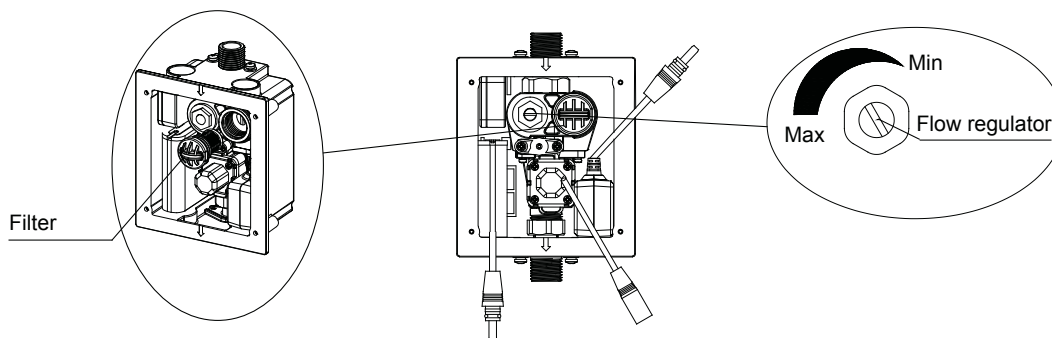

Pict.12 Flow adjustment and filter clean

Notes

- ★ No shock on the product and no press to the sensor window.
- ★ Keep tidy of the sensor window, and no water washing directly or any organic solvent.
- ★ No acid or alkaline cleanser to be allowed to the product, please clean it by soft cloth with neutral cleanser.